

RE/MAX
EXPERT

Manayunk • Philadelphia, PA

6641-49 RIDGE AVENUE

1,950 SF-5,400 SF (Divisible) Retail Building
w/ Drive-Thru

For more info, please contact:

DAN HISTON

2152751790

DANNYUNK@YAHOO.COM



PROPERTY DETAILS

- ▶ Prime location on heavily trafficked Ridge Avenue (26,000 AADT), the main retail corridor of Roxborough
- ▶ Densely populated residential area with strong retail synergy
- ▶ In close proximity to brand new Wawa and CVS on Ridge Avenue

JOIN THESE AREA TENANTS



6641-49 RIDGE AVENUE

Site Plan

For more info, please contact:

DAN HISTON

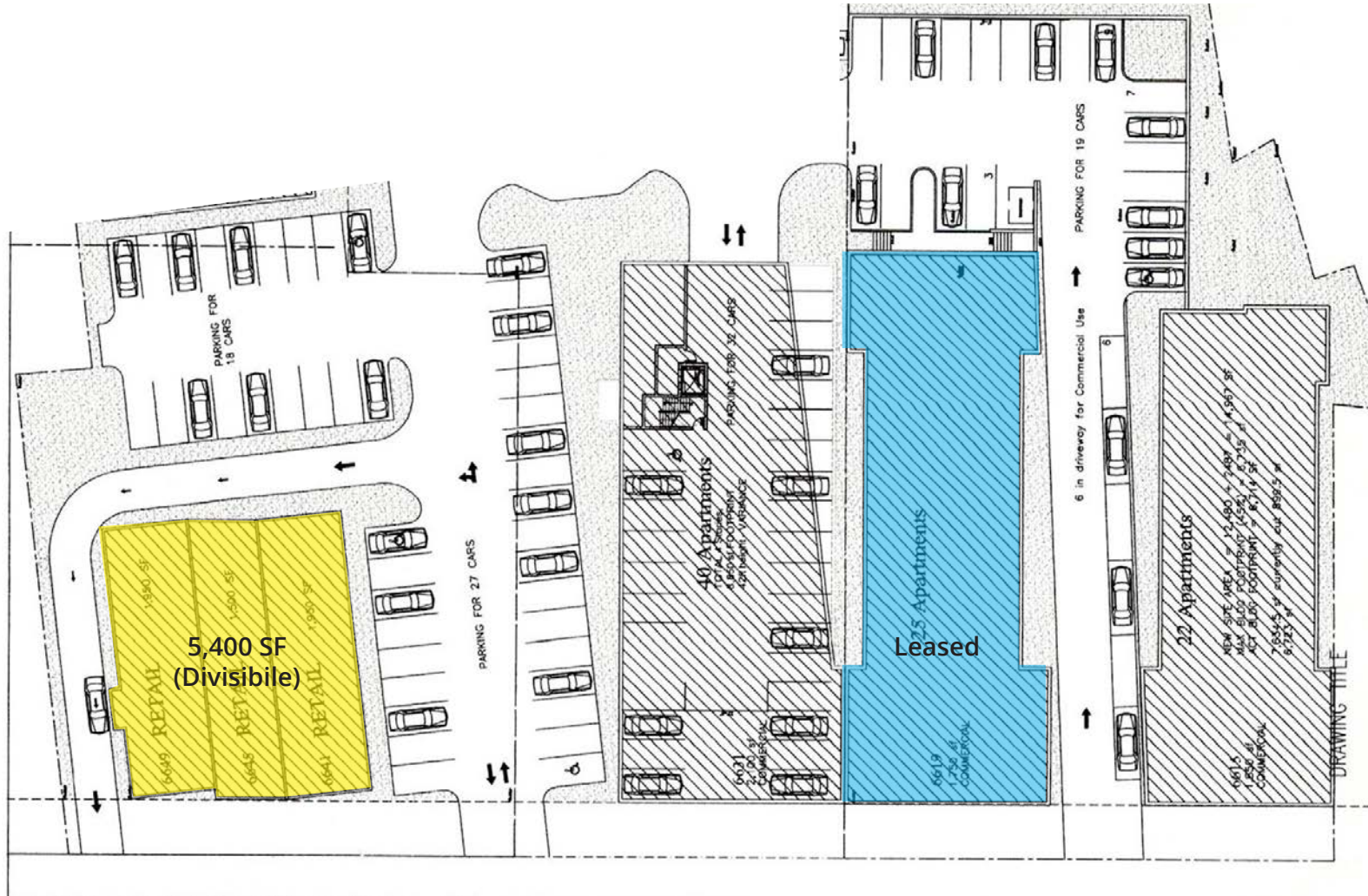

Ridge Avenue - 23,828 AADT

6641-49 RIDGE AVENUE

Aerial

For more info, please contact:

DAN HISTON

